

Energy Harness® LED Horizontal PL bulbs are ideal for a range of applications across the industrial, public, and commercial field. A pure aluminum housing provides excellent heat dissipation, leading to a long life time and high quality bulb. With a rotating base, this product is sure to provide light right where you need it, as well as use less energy than traditional lighting. Start saving on your energy costs by upgrading to the Energy Harness® LED PL bulb today!

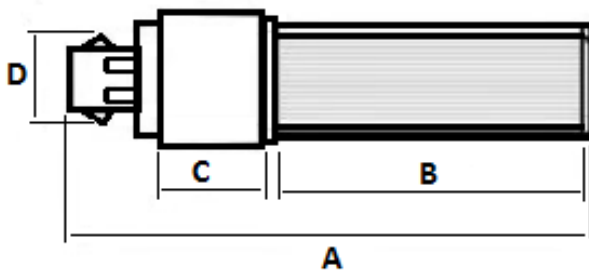

Dimensions



A = 6"
B = 3.86"
C = 1"
D = 0.82"

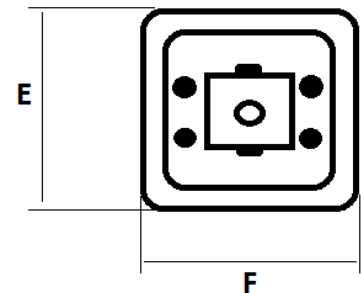

Features

- Pure aluminum housing
- UV resistant housing
- Excellent heat dissipation
- Rotatable base
- High quality SMD2835 LED chips

Applications

- Wallpacks
- Recessed Cans
- Wall Scones



Specifications

- CRI > 80
- PF > 0.9
- CCT : 4000K | 5000K
- Wattage: 9W
- Efficacy : 105LM/W
- Ballast Bypass
- Beam angle : 180°
- THD < 20%
- IP20
- Operating Temp: 25 - 45°C
- Lifespan = 50,000 hrs
- Voltage Input: 100-277VAC

Wiring

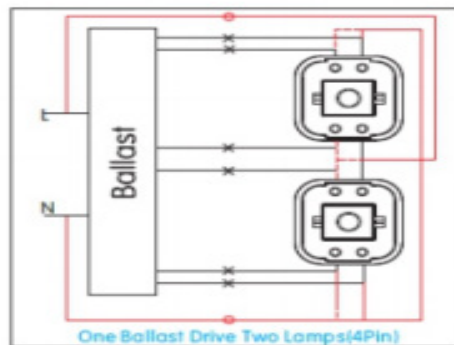
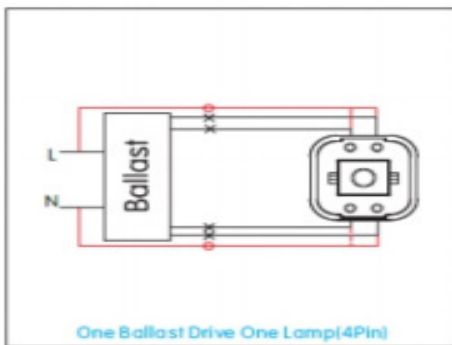

Photometric Diagram: 9W

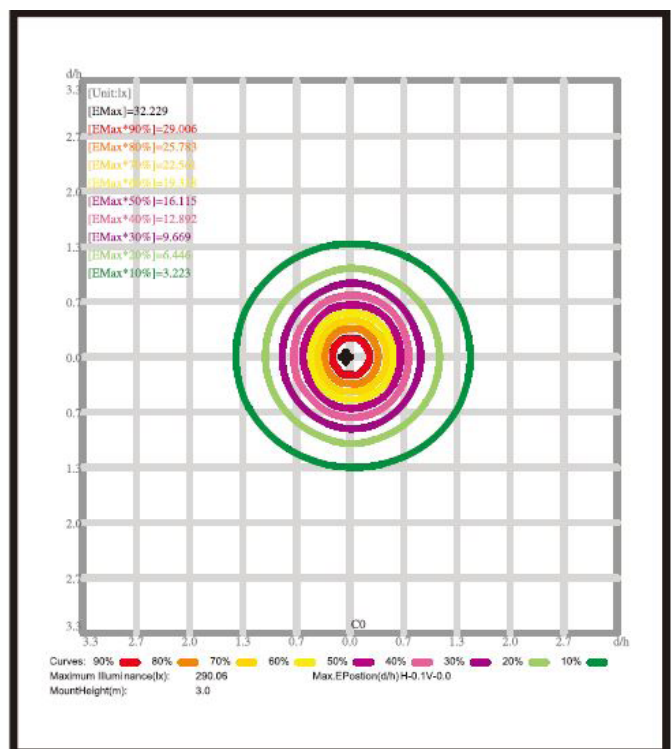
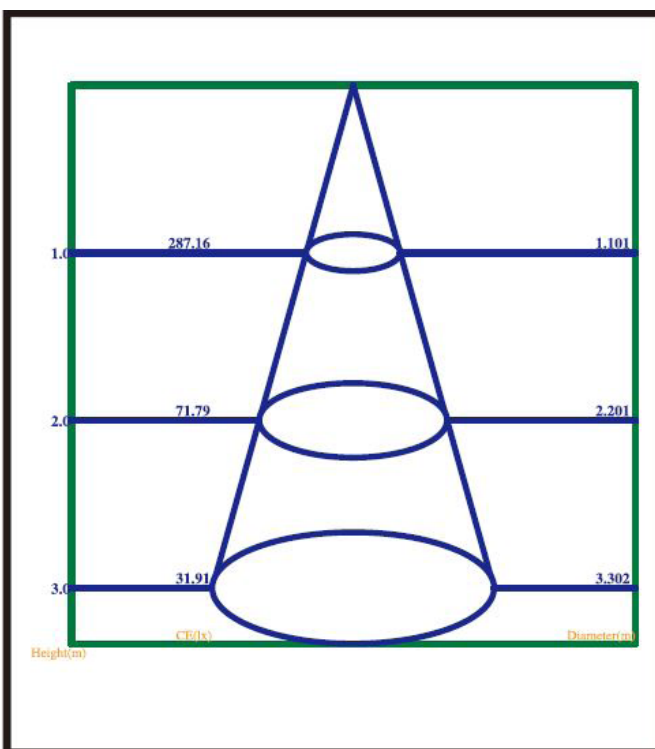

Ordering Guide

Example Model Number: EHB-PL-0940K-G24Q-277-FR

Product Series	EHF-PL
Wattage	9 = 9W
CCT	40 = 4000K 50 = 5000K
Base	G24Q
Voltage	277 = 100-277VAC
Cover	FR = Frosted

Model Number: : EHB-PL-09-__K-G24Q-277-FR

Project Name:

Date:

Specified By: